



12501 GLADSTONE AVE.
SYLMAR, CA 91342

120' x 90'

STAGE 1

Approx. 10,500 sq. ft.

Height: 22'

Cyclorama 60' x 45' x 16'

Catwalk

1800 amps-3-phase power

Silent Air Conditioning

Ample Parking

5 Production Offices

1 Kitchen

2 Restrooms

2 Roll Up Doors

Wireless Internet

*Call or email
for Rates*

818.361.2421

Delfinostudios@gmail.com

Visit us at:

www.delfinostudios.com

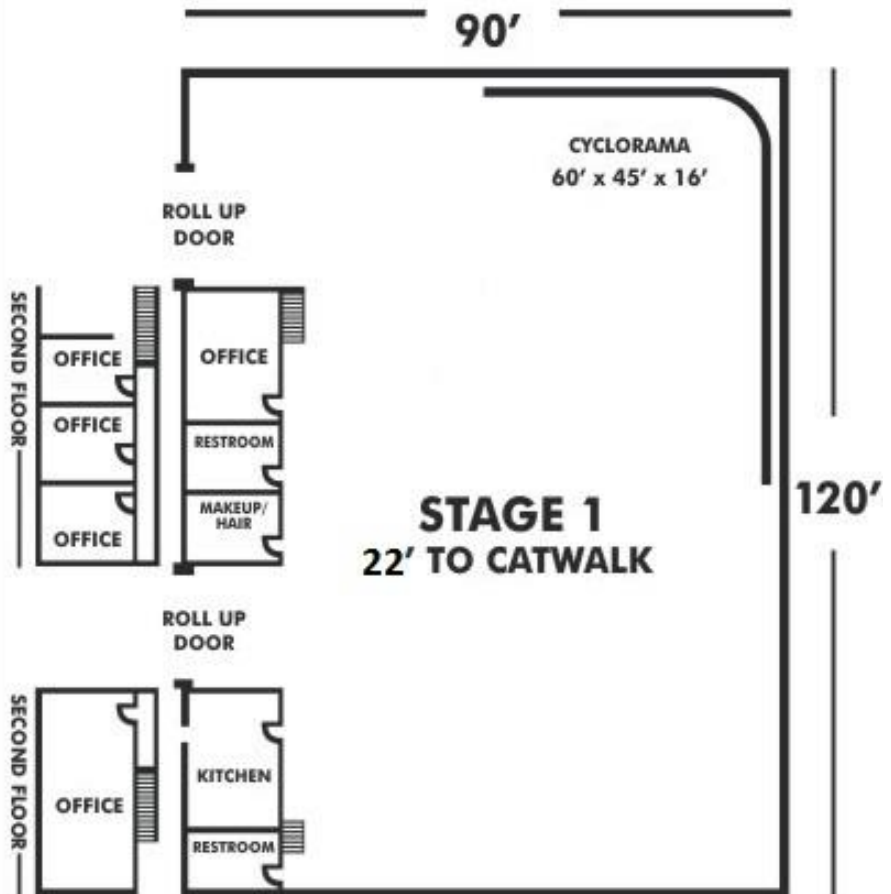



12501 GLADSTONE AVE.
SYLMAR, CA 91342

100' x 90'

STAGE 2

Approx. 9,000 sq. ft.

Height: 27'

45' x 90' Annex (4050 sq. ft)

Catwalk

1800 amps-3-phase power

Silent Air Conditioning

Ample Parking

7 Production Offices

2 Kitchens

4 Restrooms

1 Roll Up Door

Wireless Internet

Also Available:

9 Production Offices

2 Restrooms

Call or email for Rates

818.361.2421

Delfinostudios@gmail.com

Visit us at:

www.delfinostudios.com

STAGE

2
TWO

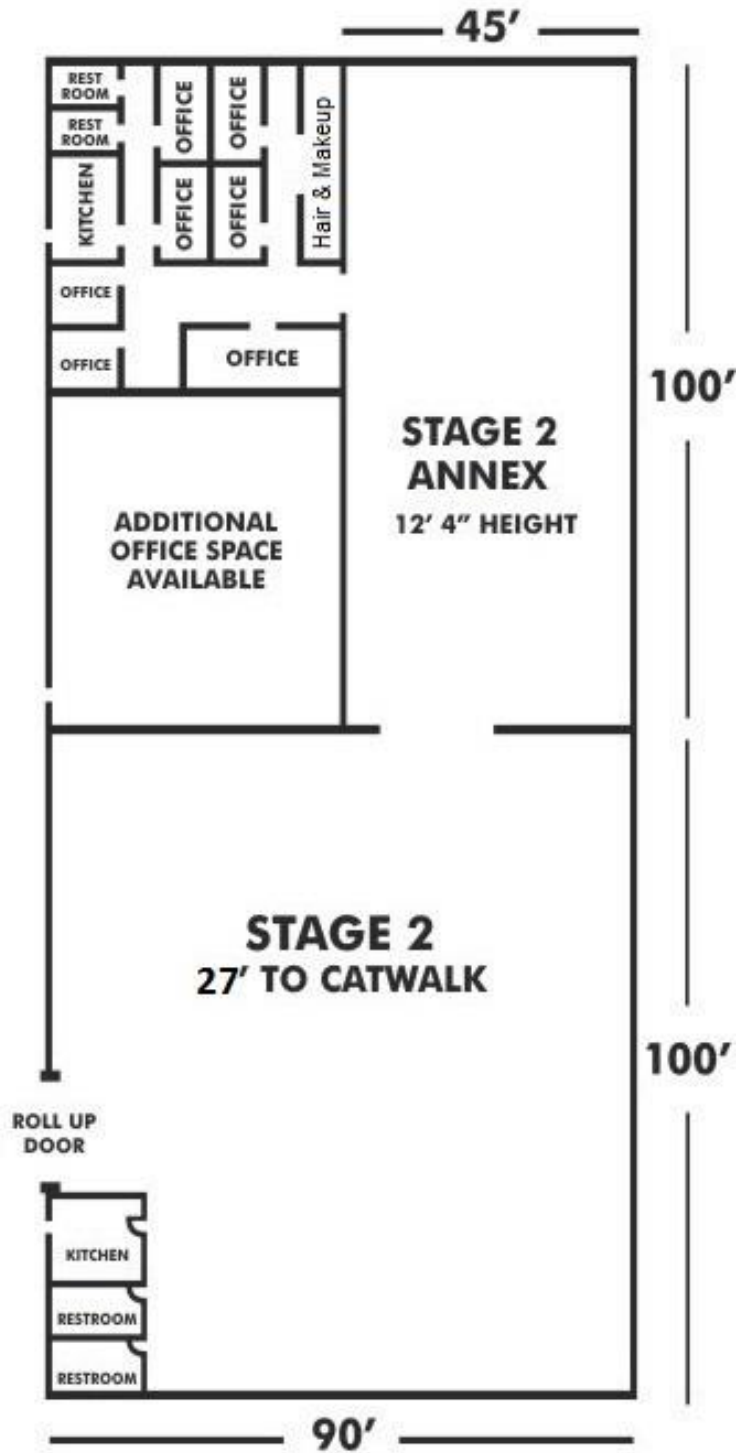



12501 GLADSTONE AVE.
SYLMAR, CA 91342

191' x 90'

STAGE 3

- Approx. 17,200 sq. ft.
- Height: 34' 8"
- 1800 amps-3-phase power
- Silent Air Conditioning
- Ample Parking
- 6 Production Offices
- 1 Kitchen
- 2 Restrooms
- 2 Roll Up Doors
- Wireless Internet

Also Available:

- 12 Production Offices
- Conference Room
- 2 Restrooms with shower facility

**Call or email
for Rates**

818.361.2421

Delfinostudios@gmail.com

Visit us at:
www.delfinostudios.com

STAGE

3

THREE

