



12501 GLADSTONE AVE.
SYLMAR, CA 91342

TEL **818.361.2421**

FAX 818.361.5891

STAGE

3

213' x 90'

- 34' 8" to Lighting Grid
- 19 Production Offices/Rooms
- Conference Room
- Kitchen
- 4 Restrooms
- Shower Facilities
- 2 Roll-up Doors
- 20 Min. From Hollywood
- Freeway Close
- Silent Air Conditioning
- Parking for 300+ Vehicles
- Office Space with Phone & Fax
- Internet Access

90'

213'

34' 8"
TO
GRID

STAGE 3



SECOND FLOOR

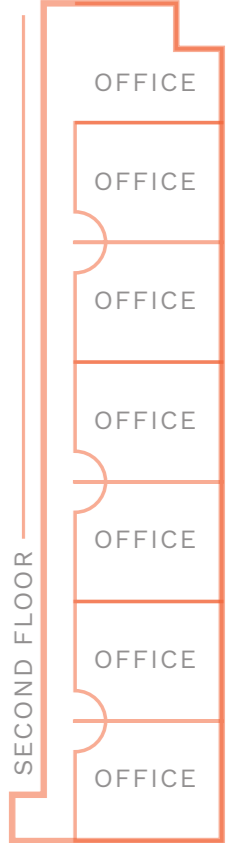

SECOND FLOOR

ROLL-UP DOOR